



#### QUICK SELECTION / Selezione veloce

input speed ( $n_1$ ) = 1400 min<sup>-1</sup>

Output Speed $n_2$ [min <sup>-1</sup> ]	Ratio $i$	Motor power $P_{1M}$ [kW]	Output torque $M_{2M}$ [Nm]	Service factor f.s.	Nominal power $P_{1R}$ [kW]	Nominal torque $M_{2R}$ [Nm]	Available B5 motor flanges			Available B14 motor flanges				Dynamic efficiency RD	Tooth Module [mm]	Ratios code	
							-B	-C	-D	-O	-P	-Q	-R				
							63	71	80	56	63	71	80				
200	7	0.75	29	2.6	1.92	75	B	B			B-C	B			82	2.5	01
140	10	0.75	41	1.9	1.43	78	B	B			B-C	B			80	2.4	02
100	14	0.75	57	1.4	1.05	79	B	B			B-C	B			79	2.6	03
78	18	0.75	69	1.1	0.81	75	B	B			B-C	B			75	2.0	04
54	26	0.55	67	1.1	0.58	71	B	B			B-C	B			69	2.7	05
47	30	0.55	79	1.1	0.61	88	B	B			B-C	B			70	2.5	12
39	36	0.37	63	1.3	0.48	82	B			B-C	B-C			69	2.1	06	
33	43	0.37	72	1.1	0.42	82	B			B-C	B-C			66	1.8	07	
28	50	0.37	78	1.0	0.36	76	B			B-C	B-C			62	1.5	13	
23	60	0.25	59	1.2	0.30	71	B			B-C	B-C			58	1.3	08	
21	68	0.25	66	1.0	0.25	66	B			B-C	B-C			57	1.2	09	
17.5	80	0.18	53	1.2	0.22	65	B			B-C	B-C			54	1.0	10	
14	100	0.12	41	1.3	0.16	55	B			B-C	B-C			50	0.8	11	

**A** Motor Flanges Available  
Flange Motore Disponibili

**B** Supplied with Reduction Bushing  
Fornito con Bussola di Riduzione

**B** Available on Request without reduction bushing  
Disponibile a Richiesta senza Bussola di Riduzione

**C** Motor Flange Holes Position  
Posizione Fori Flangia Motore

**EN** Unit M50 is supplied with synthetic oil, providing "long life" lubrication. For mounting position V5-V6 please contact us. See table 1 for lubrication and recommended quantity. In table 2 please see possible radial loads and axial loads on the gearbox.

#### LUBRICATION M50 Oil Quantity 0.14 Lt.

**SHELL** Omala S4 WE 320

**ENI** Telium VSF 320

For all details on lubrication and plugs check our website

tab. 1

Per maggiori dettagli su lubrificazione e tappi olio vedi il nostro sito web

**I** Il riduttore tipo M50 viene fornito lubrificato a vita con olio sintetico. Per posizioni V5-V6 contattare il ns. servizio tecnico. Vedi tab.1 per oli e quantità consigliati. In tab.2 sono presenti i carichi radiali e assiali applicabili al riduttore.

**D** Für die Lebensdauerschmierung ist das Getriebe der Größe M50 mit synthetischem Öl befüllt. Bei Einbaulage V5 oder V6 bitten wir um Rücksprache. In Tabelle 1 ist die Schmiermenge und das empfohlene Schmiermittel angegeben. In Tabelle 2 sind die zulässigen Radial - und Axialbelastungen des Getriebes aufgeführt.

**F** Le réducteur de type M50 est fourni lubrifié à vie avec de l'huile synthétique. Concernant les positions V5.V6, contactez notre service d'assistance technique. Voir tableau 1 concernant les huiles et les quantités conseillées. Les charges radiales et axiales applicables au réducteur sont précisées dans le tableau 2.

**E** El reductor tamaño M50 se suministra, lubricado de por vida con aceite sintético. Para las posiciones V5 y V6 contactar con nuestro servicio técnico. Ver tabla 1, para cantidades y aceites recomendados. En la tabla 2, se encuentran las cargas radiales y axiales admitidas por el reductor.

#### RADIAL AND AXIAL LOADS

##### Output shaft

Albero di uscita

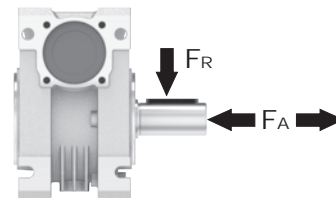

$n_2$ [min <sup>-1</sup> ]	FA [N]	FR [N]
200	240	1200
150	280	1400
100	300	1500
75	340	1700
50	380	1900
25	480	2500
15	560	2800

##### Input shaft

albero in entrata

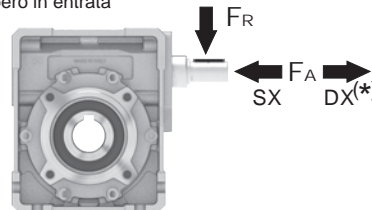

$n_1$ [min <sup>-1</sup> ]	FA [N]	FR [N]
1400	76	380

\*Strong axial loads in the DX direction are not allowed.  
Non sono consentiti forti carichi assiali con direzione DX

tab. 2

**PM50FB...** Basic wormbox  
Riduttore base

M. flanges	Kit code	∅F	A
<b>63B5</b>	K050.4.041	138	83.5
<b>71B5</b>	K050.4.042	160	81
<b>80B5</b>	K050.4.043	200	81.5
<b>56B14</b>	KC40.4.049	80	81
<b>63B14</b>	K050.4.047	90	83.5
<b>71B14</b>	K050.4.045	105	81
<b>80B14</b>	K050.4.046	120	81.5

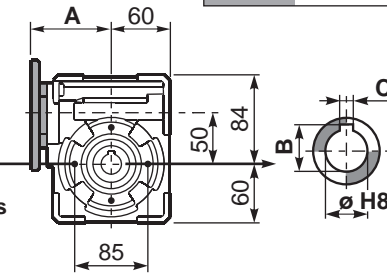
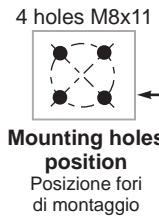
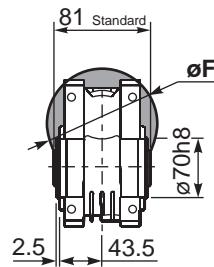

Gearbox weight  
peso riduttore **3.25 kg**

∅ H8	B	C	*Spacer code
<b>25</b> Standard	28.3	8	KM50.3.025
<b>24</b> on request	27.3	8	KM50.3.024

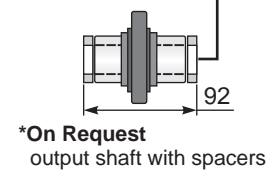

**PM50FC...** Square flange  
Flangia quadrata

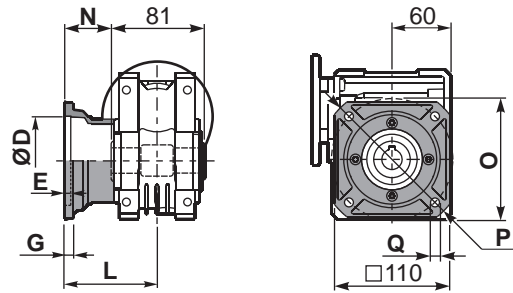

type B	∅D	E	G	L	N	O	P	Q	kit code
<b>FC</b>	70 H8	5	9	90	49.5	85	125	11	KM50.9.010
<b>FL</b>	70 H8	5	9	120	79.5	85	125	11	KM50.9.011

**PM50F1...** Round flange  
Flangia rotonda

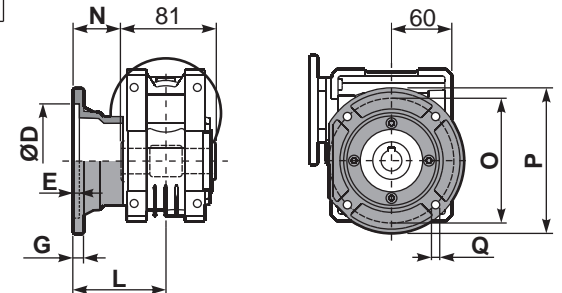

type S	∅D	E	G	L	N	O	P	Q	kit code
<b>F1</b>	110 H8	5	10	89	48.5	130	160	9.5	KM50.9.012
<b>F2</b>	95 H8	5	14.5	72	31.5	115	140	11	KM50.9.013

**PM50FB...** Feet  
Piedini

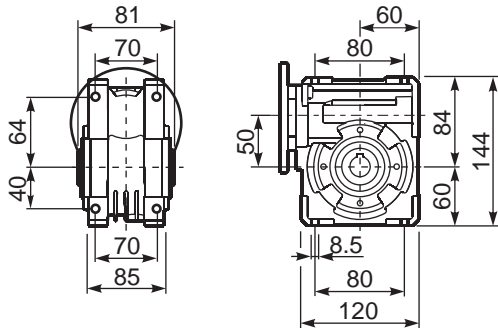

**PM50BR...** Reaction arm  
Braccio di reazione

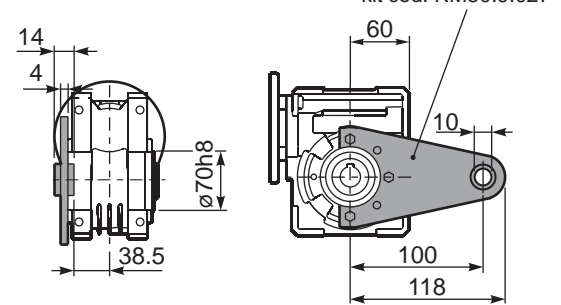

**RM50FB...** Input shaft  
Albero in entrata

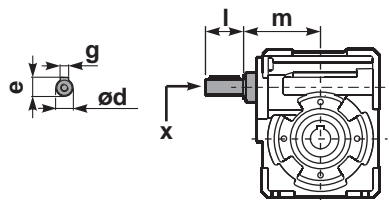

	∅d	e	g	l	m	x	kit code
type B	16 h6	18	5	30	79.5	M6x16	① K050.5.006 PAM71 ② K050.5.007 PAM80
type S	14 h6	16	5	30	79.5	M5x10	① KS050.5.008 PAM71 ② KS050.5.009 PAM80

**PM50.....S...** Single Shaft  
Albero lento semplice

**PM50.....D...** Double Shaft  
Albero lento bisp.

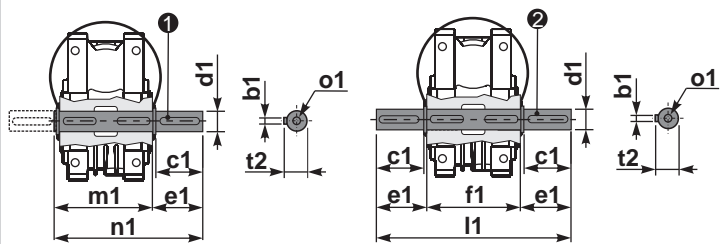

① kit cod. K050.5.028 type B  
kit cod. KS050.5.030 type S  
② kit cod. K050.5.029 type B

	b1	c1	d1	e1	f1	l1	m1	n1	t2	o1
type B	8	52	25 <sup>-0.005</sup> <sub>-0.020</sub>	59.5	81	200	86.5	146	28	M8x20
type S	8	50	24 <sup>-0.005</sup> <sub>-0.020</sub>	68.8	-	-	86.5	155	27	M8x20